

## Parts list Combiseeder

CS200

V230220

# Wearing parts

## Slijtdelen

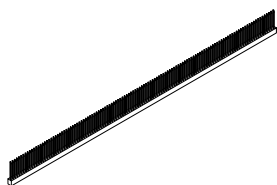

1

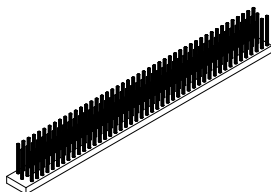

2

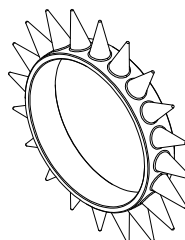

3

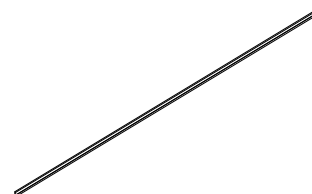

4

Item	Quantity	Part number	Description	Omschrijving
1	2	0110-0033	Brush bar 15x20x2030	Borstellat volbezet 15x20x2030
2	2	0110-0035	Brush 2070x100x30 hoh30 H130x1.5	Borstellat 2070x100x30 hoh30 H130x1.5
3	100	0111-0006	Spiked roller Combiseeder	Prikrol Combiseeder
4	10	CS20.02.009	Haired rush roller L=2065	Haren borstel rol L=2065

# Seed dispenser

CS20.02.01 - Zaad doseerbak



Item	Quantity	Part number	Description	Omschrijving
1	2	0201-0015	Bearing UCFL206	Lager UCFL206
2	1	0304-0003	Inlay key 8x7x30	Inlegspie 8x7x30
3	1	0405-0038	Chainwheel 1/2" x 5/16" t15 D30 1x key 2x	Kettingwiel 1/2" x 5/16" t15 D30 1x spie 2x
4	2	CS00.01.013	Sealplate brush	Afdichtplaat borstel
5	1	CS00.02.004	Lock plate seedunit	Sluitplaat zaadbak
6	1	CS00.08.012	Adjust lever with lockbolt hole	Afstel hendel met slotboutgat
7	1	CS00.08.02	Weld assembly hinge adjusting lever	Lassamenstelling scharnier afstel hendel
8	1	CS20.02.02	Brush axle	Borstelas
9	1	CS20.02.03	Seed dispenser	Lassamenstelling zaad doseerbak
10	1	CS20.02.04	Seed slider	Lassamenstelling zaadschuif

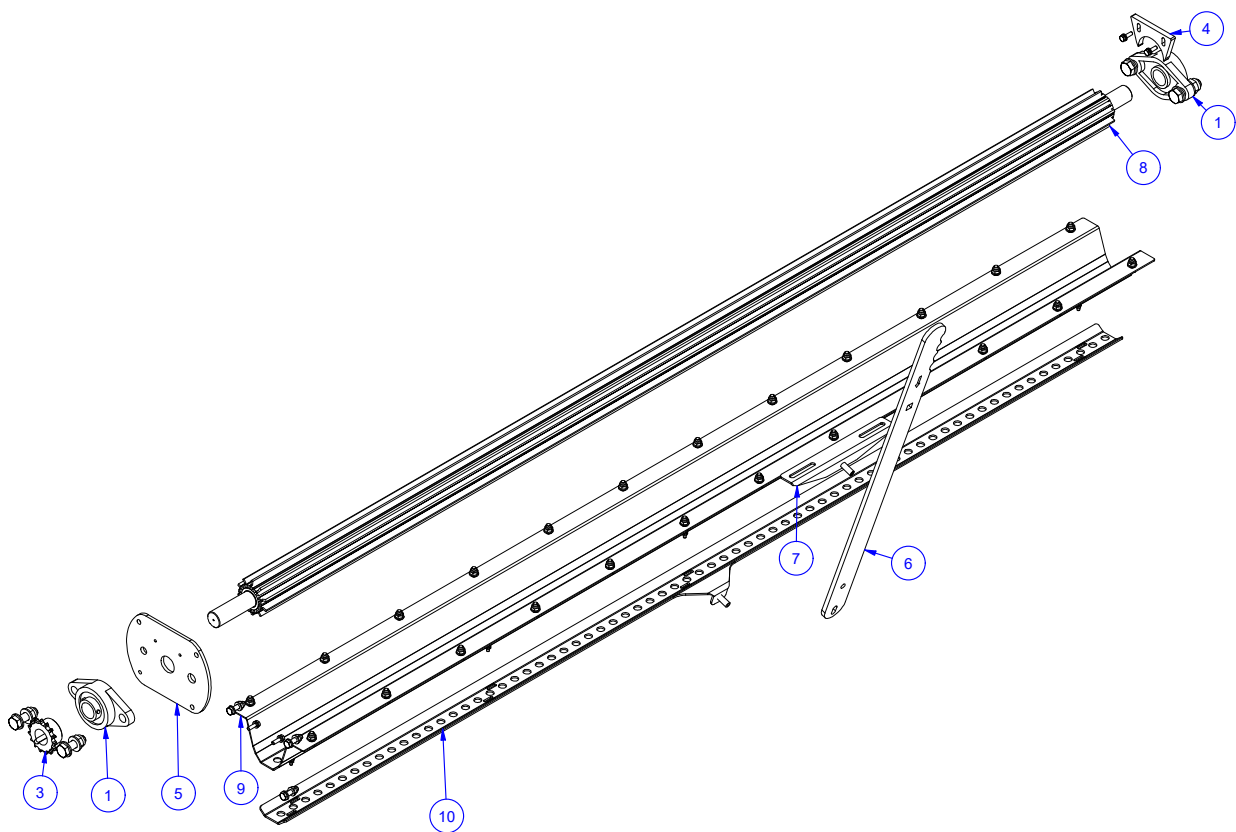

# Spiked roller back

CS20.03.01 - Prikrol achter

Item	Quantity	Part number	Description	Omschrijving
1	50	0111-0006	Spiked roller Combiseeder	Prikrol Combiseeder
2	2	0201-0015	Bearing UCFL206	Lager UCFL206
3	4	CS00.03.007	Adjustable plate roller	Stelplaat looprol
4	1	CS20.03.03	Tube spiked roller	Buis prikrol achter

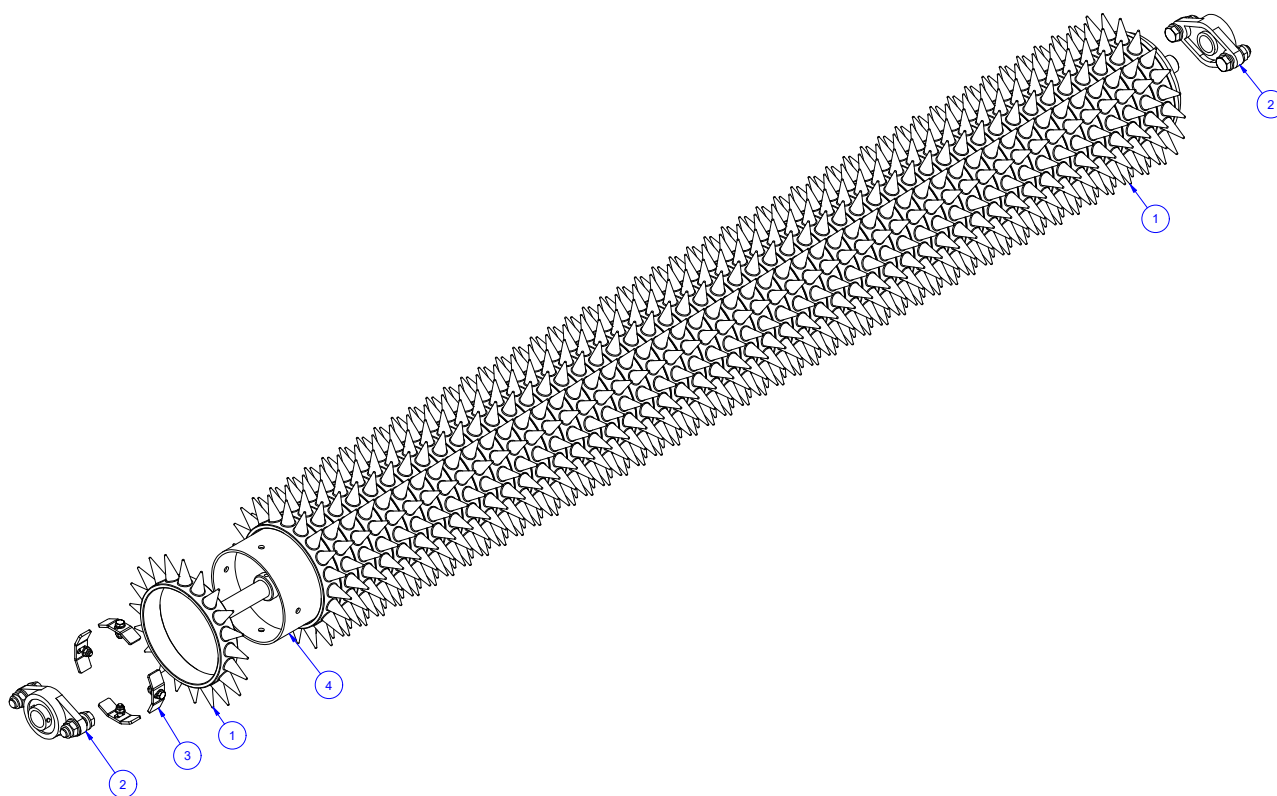

# Spiked roller front

CS20.03.02 - Prikrol voor

Item	Quantity	Part number	Description	Omschrijving
1	50	0111-0006	Spiked roller Combiseeder	Prikrol Combiseeder
2	2	0201-0015	Bearing UCFL206	Lager UCFL206
3	1	0405-0038	Chainwheel 1/2" x 5/16" t15 D30 1x key 2x	Kettingwiel 1/2" x 5/16" t15 D30 1x spie 2x
4	1	8 x 7 x 30 - DIN 6885	Inlay key	Inlegspie
5	4	CS00.03.007	Adjustable plate roller	Stelplaat looprol
6	1	CS20.03.04	Tube spiked roller	Buis prikrol voor

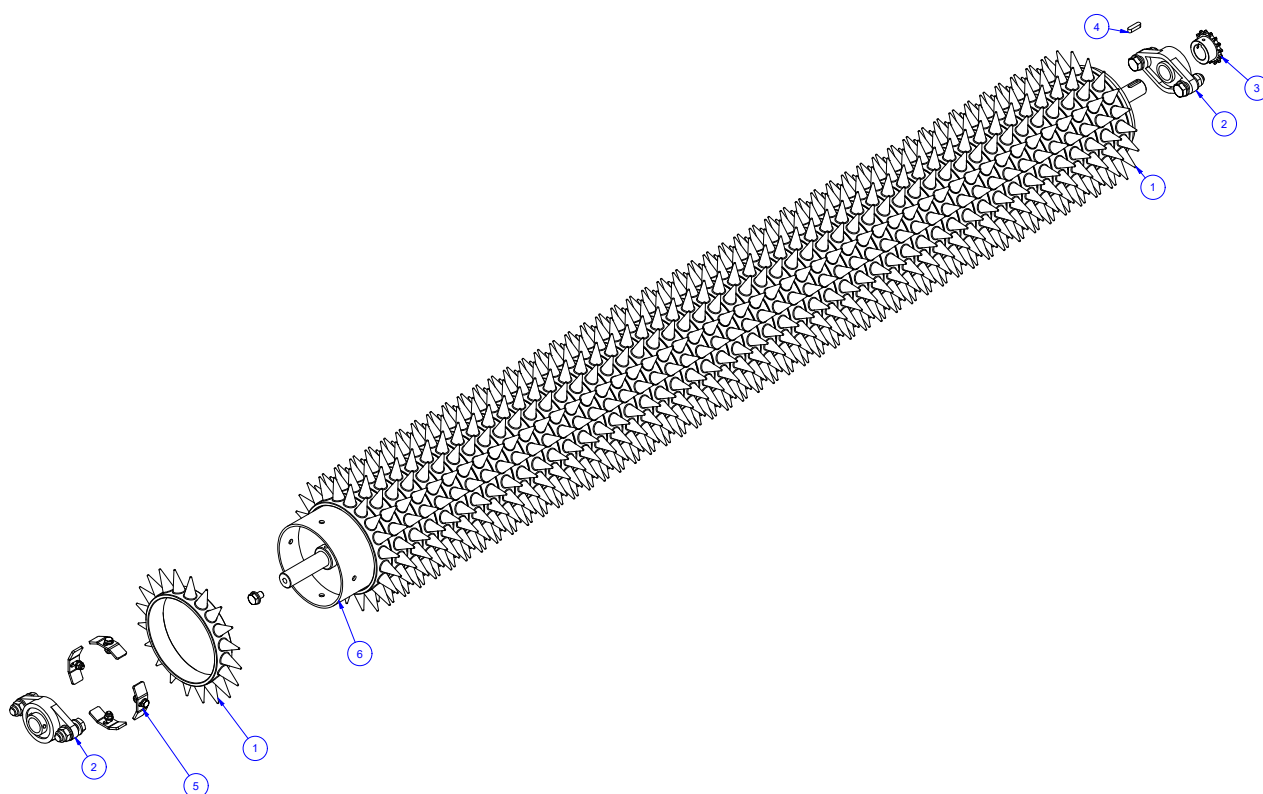

# Sweeper brush

CS20.06.05 - Naveeg borstel



Item	Quantity	Part number	Description
1	1	CS20.06.06	Frame sweeper brush
2	1	0110-0035	Brush 2070x100x30 hoh30 H130x3
3	11	9926-0001	Screw VZ CK TX-25 5.0X40 KP

## Omschrijving

Frame naveeg borstel nieuwe model

Borstellat 2070x100x30 hoh30 H130x1.5

Unischroef VZ CK TX-25 5.0X40 KP

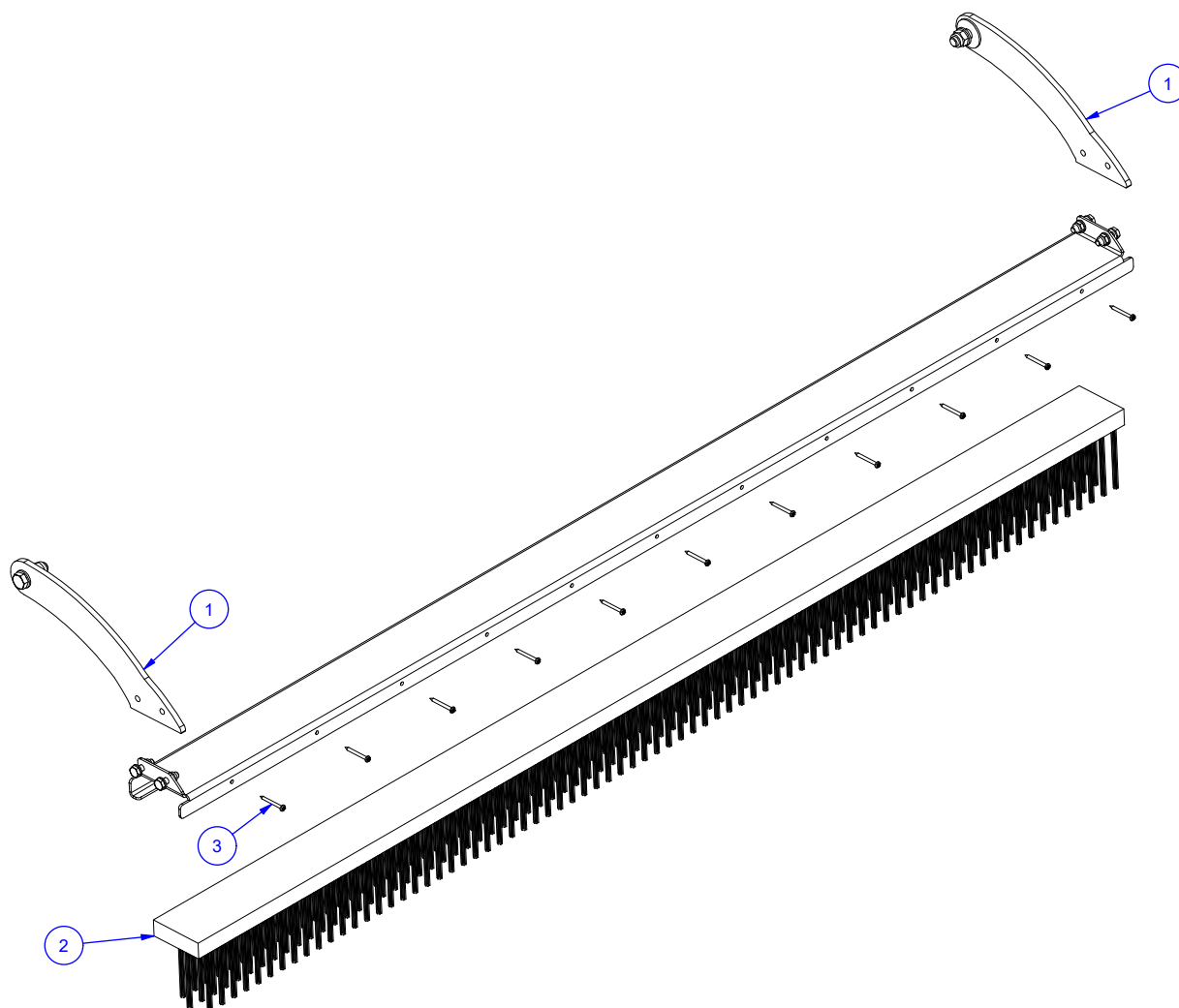

# Frame brush

CS20.06.08 - Frame borstel



Item	Quantity	Part number	Description
1	1	0110-0035	Brush 2070x100x30 hoh30 H130x3
2	2	1003-0002	Support leg GKB 02
3	10	9926-0001	Screw VZ CK TX-25 5.0X40 KP
4	1	CS20.06.07	Frame brush

## Omschrijving

Borstellat 2070x100x30 hoh30 H130x1.5  
 Steunpoot GKB 02  
 Unischroef VZ CK TX-25 5.0X40 KP  
 Frame borstel nieuw type

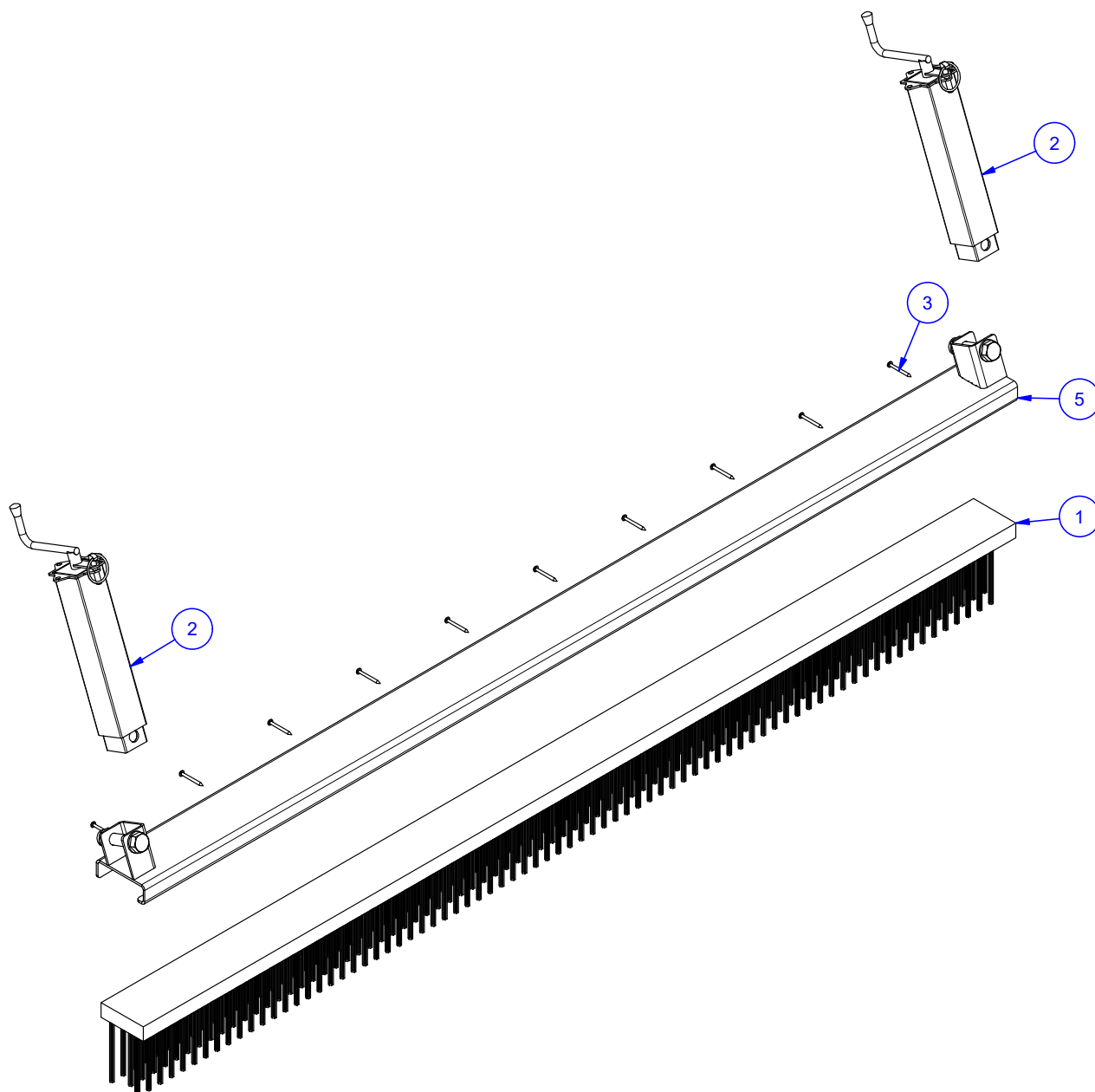

# Scraper front roller

CS20.07.01 - Schrapper voorste rol



Item	Quantity	Part number	Description	Omschrijving
1	1	0110-0033	Brush bar 15x20x2030	Borstelstaf volbezet 15x20x2030
2	1	CS20.07.02	Scraper front roller	Schrapper voorste rol
3	17	ISO 7049 - ST4,2x19-C-H	Tapping Screw	Tapschroef

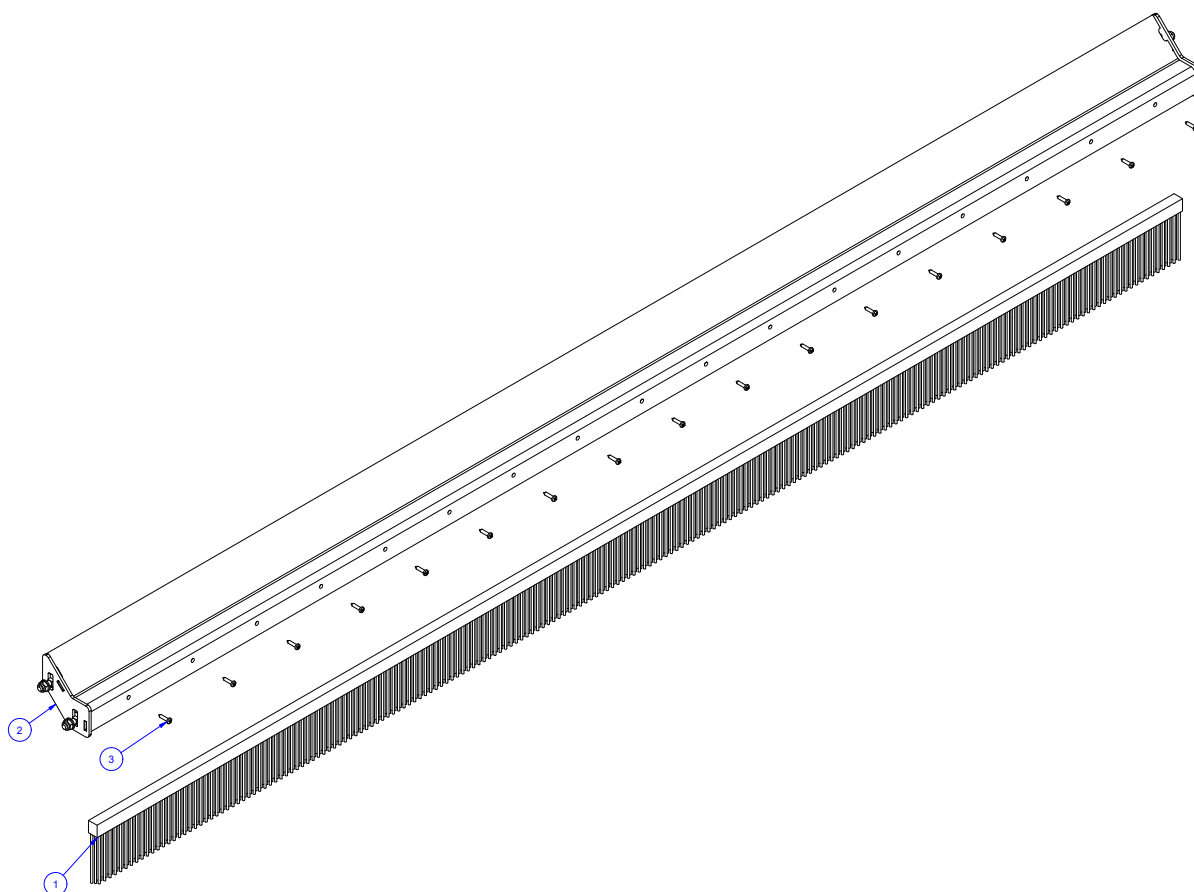



# Scraper back roller

CS20.07.03 - Schraper achterste rol



Item	Quantity	Part number	Description	Omschrijving
1	1	0110-0033	Brush bar 15x20x2030	Borstelstaf volbezet 15x20x2030
2	1	CS20.07.04	Scraper back roller	Schraper achterste rol
3	17	ISO 7049 - ST4,2x19-C-H	Tapping Screw	Tapschroef

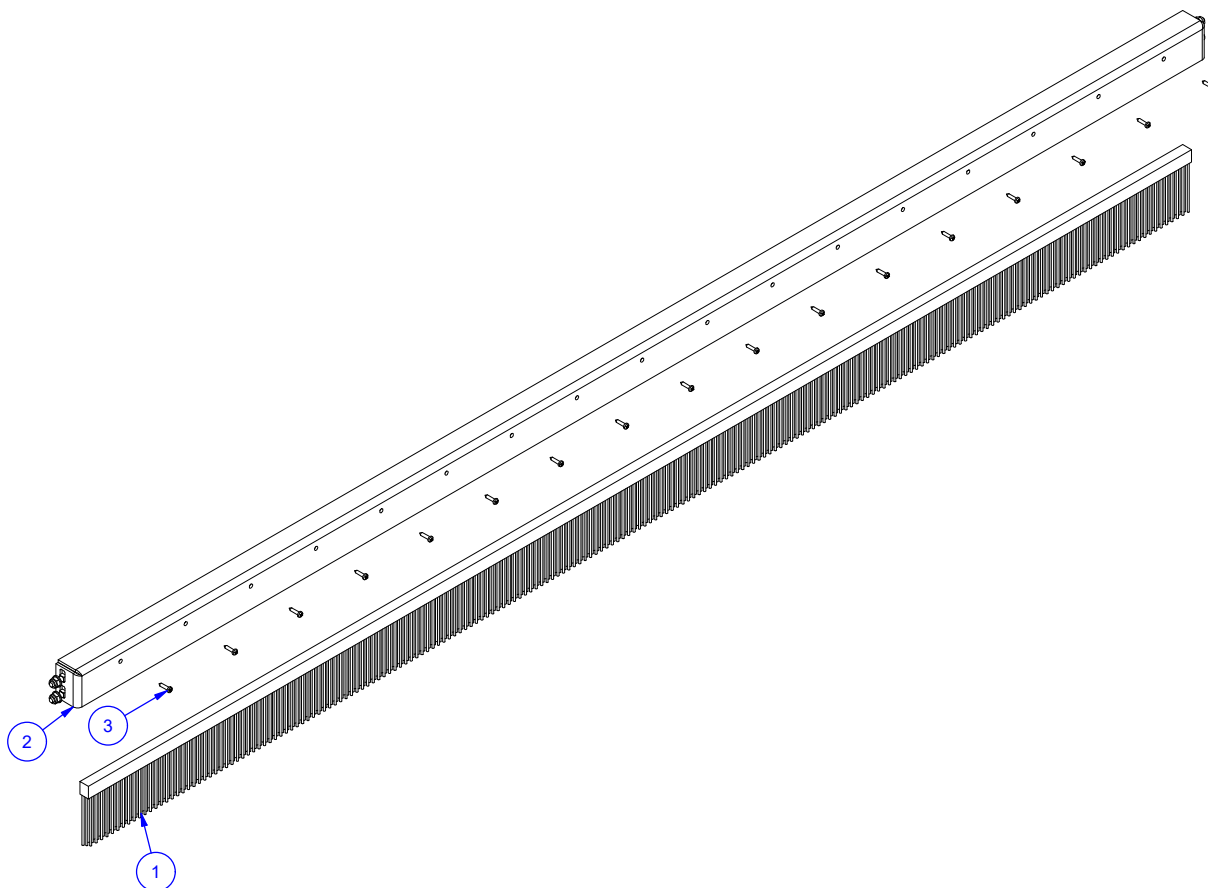

# Combiseeder 200

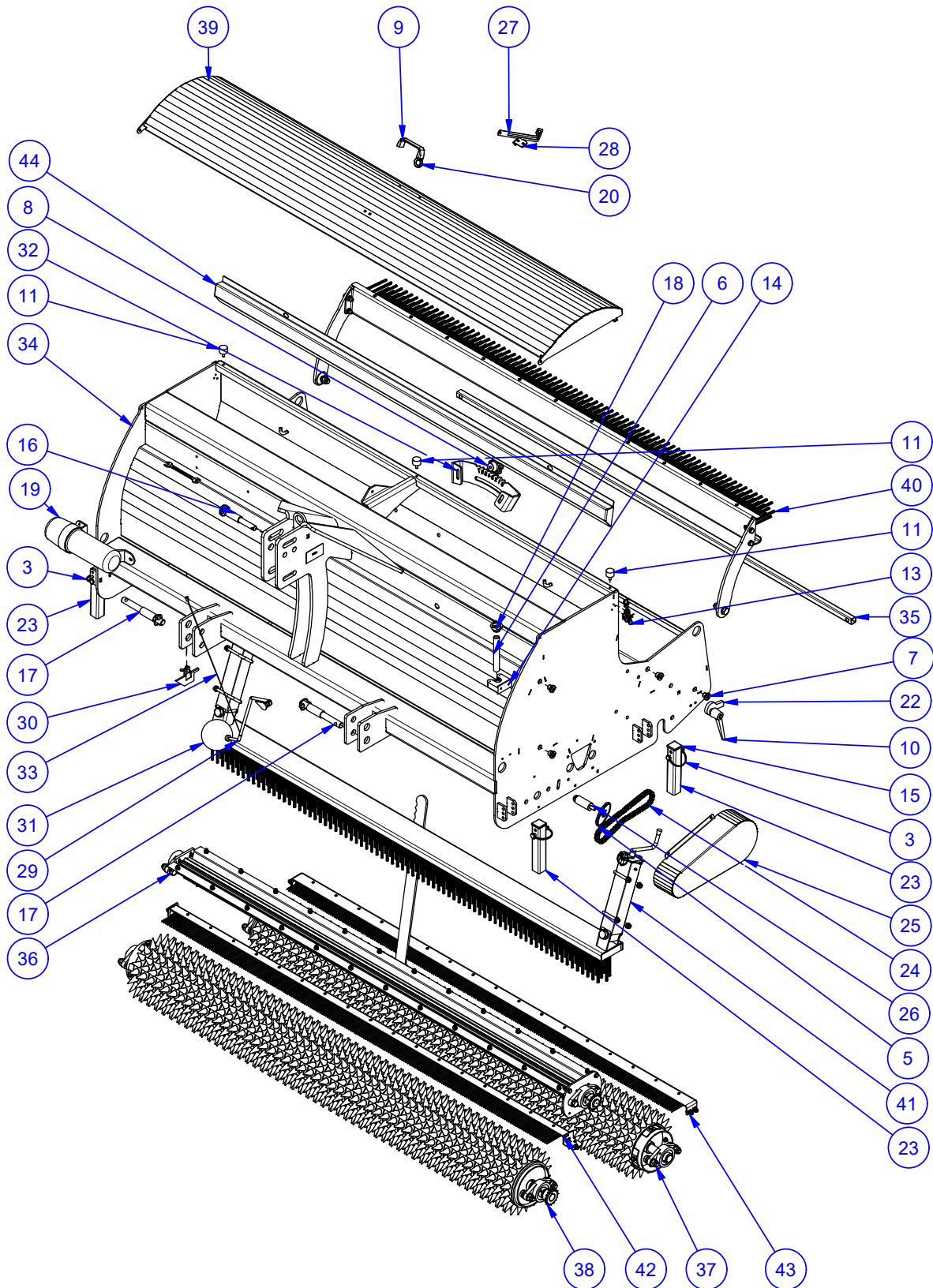

# Combiseeder 200



Item	Quantity	Part number	Description	Omschrijving
1	2	0305-0001	Pin 11mm	Borgpen 11mm
2	1	0305-0003	Pin 6mm	Borgpen 6mm
3	4	0306-0001	Tube pin 9,5x68	Buisborgpen 9,5x68
4	2	0308-0004	Circlip 8x130	Borgveer 8x130
5	1	0414-0001	Tensioner 1/2" chain	Glijelement 1/2" ketting
6	1	0511-0003	Pipe nipple 1/2"x150mm	Pijpnippel verz. 1/2"x150mm
7	6	0516-0001	Blind stop 1/2 BSP	Blindstop 1/2 BSP
8	1	0601-0001	Star handle M12	Sterknop M12
9	1	0603-0002	Handle cover seed container	Handgreep Afdekkap bunker
10	2	0603-0004	Clamp handle bolt	Klemgreepmoer M12
11	3	0801-0001	Vibration damper 3020 M8	Trillingsdemper 3020 M8
12	4	1004-0002	U-bracket square 70 M10	U-beugel vierkant 70 M10
13	2	1102-0001	Flap closure	Klepsluiting
14	1	1102-0008	Clamp 20-30mm	Klem 20-30mm
15	4	1204-0002	Insert square 40x40x4mm	Inzetstuk vierkant 40x40x4 mm
16	1	1401-0006	Link pin 19/25	Topstangpen met verloop 19/25
17	2	1401-0007	Link pin 22-28	Topstangpen met verloop 22/28
18	1	2001-0001	Geka 1/2" bi.	Geka 1/2" bi.
19	1	7090-0002	Manual box	Handleiding houder box
20	2	9927-0001	Screw nipple 3,0 mm, ton 8x12 mm	Schroefnippel 3,0 mm, ton 8x12 mm
21	1	CS00.01.013	Sealing plate brush	Afdichtplaat borstel
22	2	CS00.01.030	Bushing height adjustment brush	Bus hoogte verstelling borstel
23	4	CS00.01.036	Support CS	Pootje CS
24	1	CS00.02.01	Chain + connecting link	Ketting + sluitschakel CS
25	1	CS00.04.01	Weld assembly chain cover	Lassamenstelling kettingkast
26	1	CS00.04.005	Axle 40 POM L=66.5	As40 POM L=66.5
27	1	CS00.05.004	Holder cover	Haak afdekkap
28	1	CS00.05.006	Mounting hook	Bevestiging haak
29	1	CS00.08.05	Assembly float arm	Montage samenstelling vlotterarm
30	1	CS00.08.007	Fillpiece collectionbox	Vulstuk opvangbak
31	1	CS00.08.010	Plastic float ball Ø4,5"	Kunststof vlotterbal 4,5" dia
32	1	CS00.08.011	Adjusting plate seed dispenser	Keuzeplaat
33	1	CS00.08.018	Cable floating ball	Remkabel - Vlotter stang
34	1	CS20.01.02	Frame	Frame
35	1	CS20.01.009	Tube 25x25x2 L=2070mm	Koker 25x25x2 L=2070,000 mm
36	1	CS20.02.01	Seed dispenser+brush	Samenstelling zaad doseerbak+borstel
37	1	CS20.03.01	Spiked roller back	Prikrol achter
38	1	CS20.03.02	Spiked roller front	Prikrol voor
39	1	CS20.05.01	Cover container	Afdekkap
40	1	CS20.06.05	Sweeper brush	Naveeg borstel achter nieuw type
41	1	CS20.06.08	Frame brush	Frame borstel nieuw type
42	1	CS20.07.01	Scraper back roller	Schrapper voorste rol compleet
43	1	CS20.07.03	Scraper front roller	Schrapper achterste rol compleet
44	1	CS20.08.007	Seed collection tray	Zaad opvangbak